

SBB De 4/4 - NEXT18 DECODER INSTALLATION

1

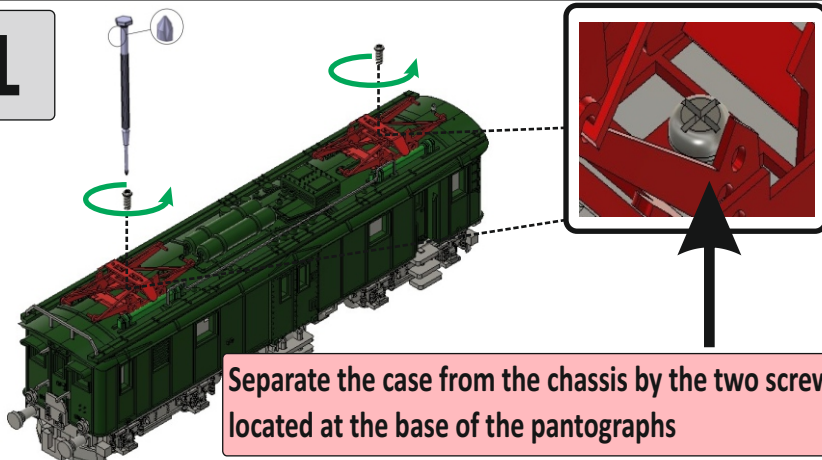

2

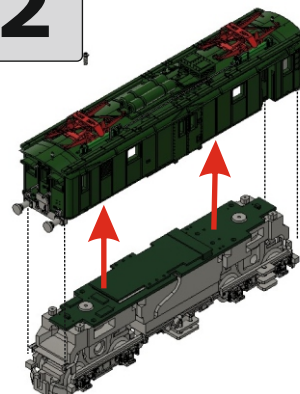

3

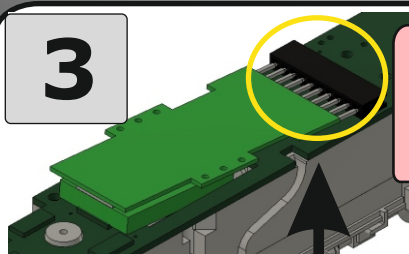

Unhook the adapter from the main board:
1- lift it slightly upward
2- pull it out in the direction opposite to the plug



Caution
excessive tilting could
damage the electronics!!

1

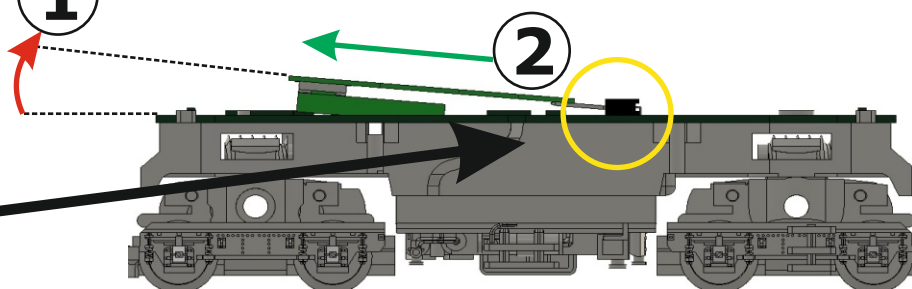

2

4

Pull the "Dummy" card out of the adapter.

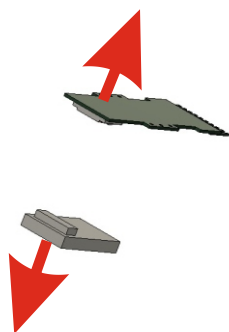

5

Plug the decoder into the Next18 socket.

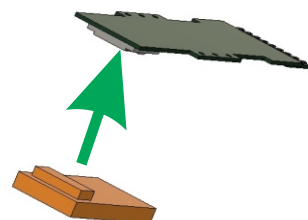

6

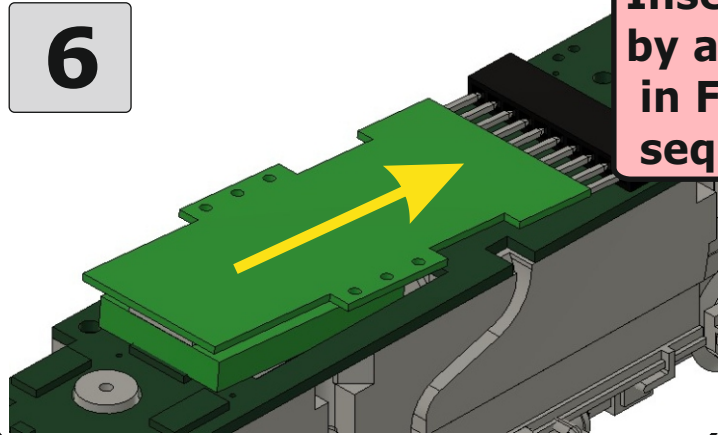

Insert the adapter into the main board by adopting the procedure shown in Figure 3, this time in reverse sequence.

7

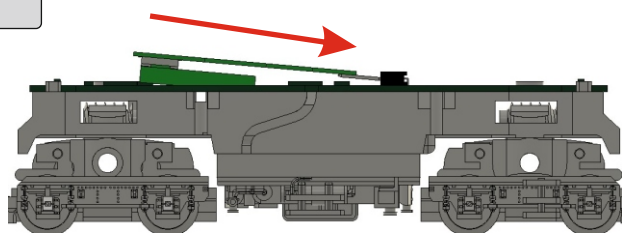

8

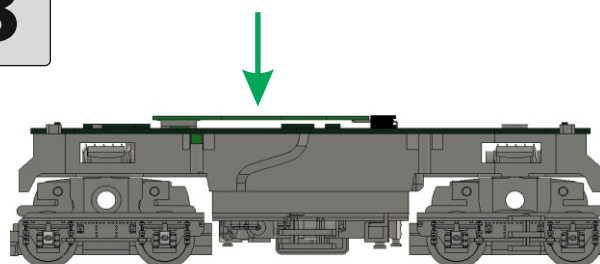

9

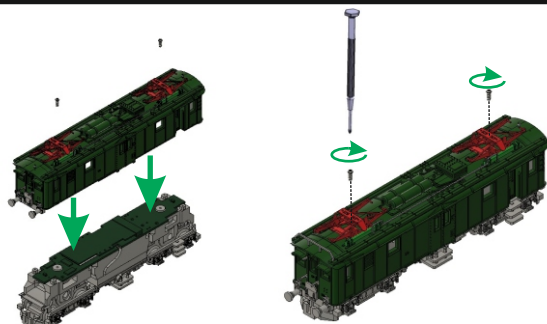

After mounting the case, you can start programming; if you are not using one of our decoders, we refer you to the instructions provided by the manufacturer.

